



Therapy Without Compromise.

Bacteriostatic Protection

Manages bioburden.

Provides a protective **bacteriostatic** environment.

Broad spectrum, including MRSA and VRE.

Binds harmful endotoxins.¹

Active agents (Crystal Violet and Methylene Blue) are **bound** to the dressing to **inhibit** the growth of **microorganisms**.

Highly absorptive foam dressing.

Pulls bacteria-laden **exudate** up and **away** from the wound.

Absorption capacity **four times** greater than leading silver dressing.²

¹ Test data vs. *E. Coli* endotoxin on file.

² Data on file. Dressing absorbency based on surface area comparing Hydrofera Blue™ Dressing and Aquacel® AG.

Aquacel AG is a registered trademark of E.R. Squibb & Sons, LLC.
Acticoat is a trademark of Smith & Nephew.
SilvaSorb is a trademark of Acrymed, Inc.

Built-In Flexibility

May be used with other therapies.

Compatible with enzymatic debriders.

Does not harm growth factors.

Easy to use.

Soft and comfortable on the skin.

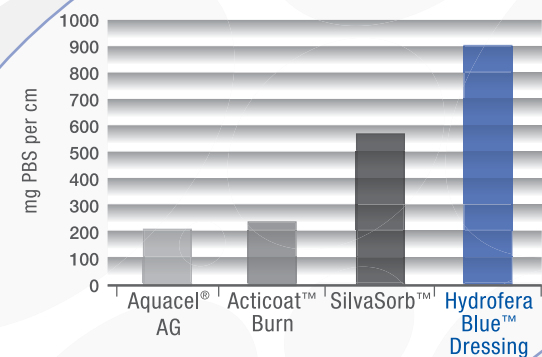

Efficacious Therapy.

For partial- and full-thickness acute and chronic wounds.

Effective against the following microorganisms:

Bacteria

Methicillin-resistant Staphylococcus aureus (MRSA)

Staphylococcus aureus

Staphylococcus epidermidis (coagulase negative)

Pseudomonas aeruginosa

Pseudomonas fluorescens

Escherichia coli

Enterococcus faecalis

Vancomycin-resistant enterococcus (VRE)

Streptococcus pyogenes

Klebsiella pneumoniae

Proteus mirabilis

Proteus vulgaris

Enterobacter aerogenes

Enterobacter cloacae

Bacillus subtilis

Yersinia enterocolitica

Serratia marcescens

Yeast

Candida albicans

Candida krusei

Candida glabrata

Hydrofera Blue™ Dressing is not indicated for third-degree burns.

SKU Descriptions

Standard Dressings	Available Sizes	Qty. per Box (5 boxes per case)
HB2214	2" x 2"	10
HB4414	4" x 4"	10
HB6614	6" x 6"	10
HB0906	9mm Diameter Tunneling Dressing (1.2 gm)	10 pair
Heavy Drainage Dressings		
HBHD4450	4" x 4" x .5" thick	5
HBHD6675	6" x 6" x .75" thick	5
Dressings with Moisture Retentive Film		
HBRF4414	4" x 4"	10
HBRF2258	2.25" x 8"	10
HBRF4475	2" x 2.75" Island Dressing (Border 4" x 4.75")	10
HBRF2650	2.5" Diameter Ostomy Dressing	10

Secondary Dressings

Level of Exudate	Secondary Dressing Examples
Low	Semi-Occlusive Film Occlusive Film Vaseline Gauze
High	Bordered Gauze Rolled Gauze

Select a secondary dressing that will help maintain the moisture content of Hydrofera Blue™ Dressing.

Application Instructions (1-3)



After applying sterile gloves, **remove** Hydrofera Blue™ Dressing from the package, and thoroughly **moisten** it with **sterile** saline or **sterile** water.



Once Hydrofera Blue™ Dressing is thoroughly moistened, **squeeze** out the excess liquid.

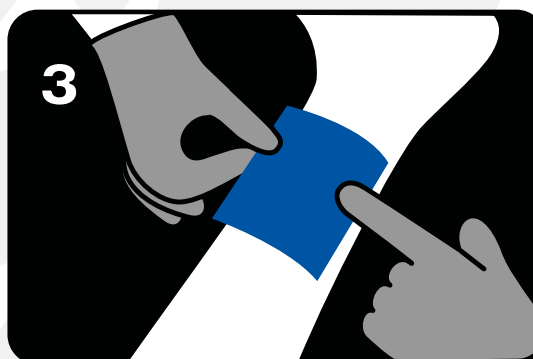

Apply the dressing to the wound. If the wound presents with surrounding erythema or rolled wound edges, the dressing should be **larger** than the wound to cover the **periwound** area. In other wounds, the dressing may be **cut** to **fit** the wound bed.

Application Instructions (4-6)

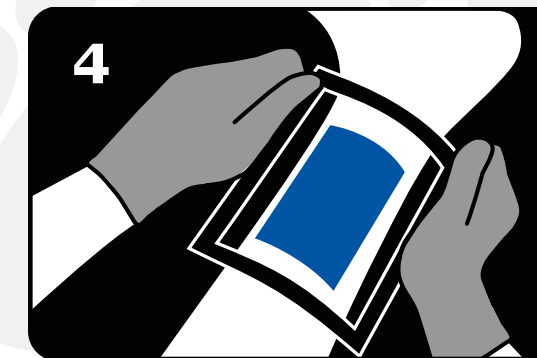

Cover Hydrofera Blue™ Dressing with a **secondary** dressing to prevent displacement and to maintain **moisture** content.

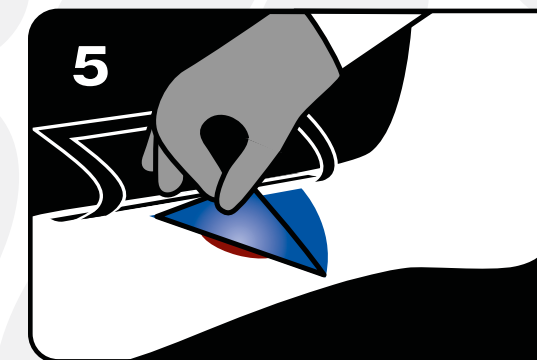

The **first** dressing change should occur at **24 hours**. Examine the area of the dressing in contact with the wound bed. If the dressing has turned **white** or **lightened** in color, the dressing should be changed again at **24 hours** until the dressing retains its color. If the dressing has **retained** its **color** where it is in contact with the wound, a new dressing can be applied and left in place for up to **72 hours**. Hydrofera Blue™ Dressing also should be changed upon strikethrough drainage.

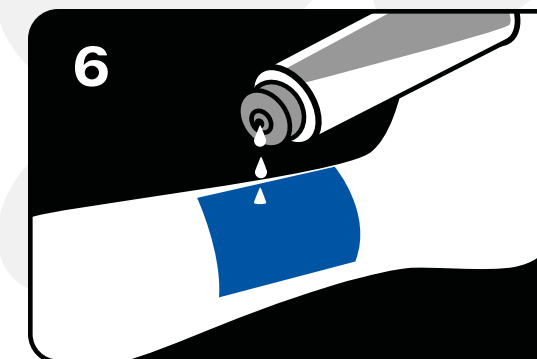

Do not allow the dressing to completely **dry out**. Rehydrate the dressing as needed. If the dressing does **dry out**, thoroughly **moisten** it with **sterile** saline or **sterile** water, **wait** 2 minutes, then **gently** remove the dressing.